

RMW1 Low Profile Weigh Module

Overview

The Loadstar RMW1 Series stainless steel weigh module is ideal for use in tank, hopper, vessel, and many other applications. The low-profile design allows for economical solutions in a competitive marketplace. This rugged, high-precision mount is designed for easy installation and does not require check rods or other stabilizing hardware. The stainless steel construction and welded seal offer additional protection in washdown areas.

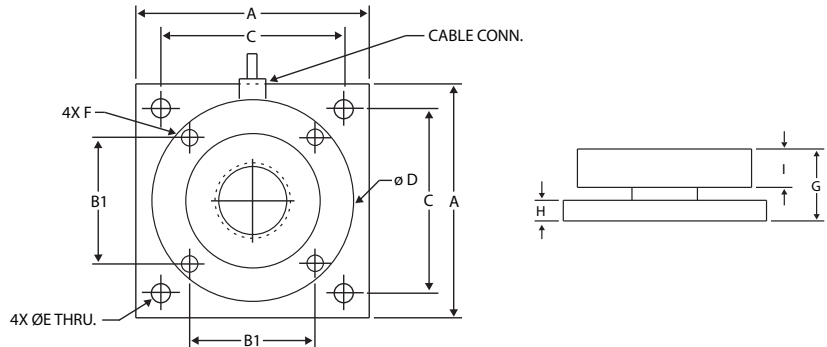

Highlights

Standard Features

- ★ Very low profile design
- ★ Self-centering
- ★ Offers 100% sideload, 100% uplift and 150% safe load and 300% ultimate overload protection

Applications

- ★ Tank, hopper, or vessel weighing
- ★ Scale platforms and screw feeders

Dimensions

| Capacity | Dimensions in inches | | | | | | | | |
|----------|----------------------|------|------|------|------|--------|------|-------|------|
| | A | B1 | C | D | E | F | G | H | I |
| 1k-10k | 4.00 | 2.00 | 3.25 | 3.50 | 0.40 | 3/8-16 | 1.35 | 0.375 | 0.75 |
| 15k | 4.00 | 2.00 | 3.25 | 3.50 | 0.40 | 3/8-16 | 1.60 | 0.625 | 0.75 |
| 20k-50k | 7.00 | 3.75 | 5.50 | 6.00 | 0.63 | 1/2-13 | 2.48 | 0.75 | 1.30 |
| 60k-100k | 8.00 | 4.75 | 6.50 | 7.00 | 0.81 | 3/4-16 | 2.50 | 1.00 | 1.30 |

Accuracy Specifications

| Accuracy | |
|----------------|-----------------------|
| Combined Error | ± 0.03% of Full Scale |

Load Cell Specifications

| | |
|-----------------------------|---------------------|
| Safe Overload | to 150% of capacity |
| Rated Excitation | 10V DC |
| Full Scale Output | 3 mV/V ± 0.1% |
| Connections | 25 ft Cable |
| Bridge Resistance | 350 Ohm |
| Insulation | 5,000 MΩ |
| Material | Stainless Steel |
| Operating Temperature Range | 0°F to 150°F |
| Seal Type | IP67 |

Compatible Accessories

Recommended Interfaces



DI-100U/DI-1000U
Digital Load Cell Interface



DI-1000Z
Wireless Load Cell Interface



AI-1000
Signal Conditioner



RD-1000
Resistive Load Cell Display

Ordering Information

| Multiple Capacities | |
|---------------------|------------|
| Four Module | Part No. |
| 1000 lb | RMW1-01K-S |
| 2500 lb | RMW1-2HK-S |
| 5000 lb | RMW1-05K-S |
| 10000 lb | RMW1-10K-S |
| 15000 lb | RMW1-15K-S |
| 20000 lb | RMW1-20K-S |

Wiring Information

| Cable Color Code | |
|------------------|--------------|
| Green | + Excitation |
| Black | - Excitation |
| Red | + Signal |
| White | - Signal |
| Shield | Bare |
| Blue | + Sense |
| Brown | - Sense |

Certifications



Wireless Load Cell Configuration



USB Load Cell Configuration



Analog Load Cell Configuration



Four Load Cell Configuration

